

733 SUMMER STREET



OFFICE SPACE AVAILABLE

Partial 5th Floor, Suite 501: 1,150 SF – 11/1/17 Occupancy

PARKING: 3 SPACES PER 1,000SF.

TERM: LONG & SHORT TERM AVAILABLE.

BASE RENT: \$22 PSF + ELECTRIC.

ALL SUITES TURNKEY OR PRE BUILT NEW!

STEPS FROM PRIME DOWNTOWN STAMFORD.

Exclusive Agent

PLAZA REALTY & MANAGEMENT CORPORATION

Gene Rubino Phone: 203-653-6541 Email: grubino7@aol.com

Michael Lombardo Phone: 203-653-6535 Email: mgl@plazarealtymgmt.com

www.plazarealtymgmt.com

SUITE 501 FLOORPLAN

5TH FLOOR SUITE 501

733 SUMMER STREET, STAMFORD, CT
PLAN OF EXISTING CONDITIONS - 5TH FLOOR
SCALE: N.T.S.

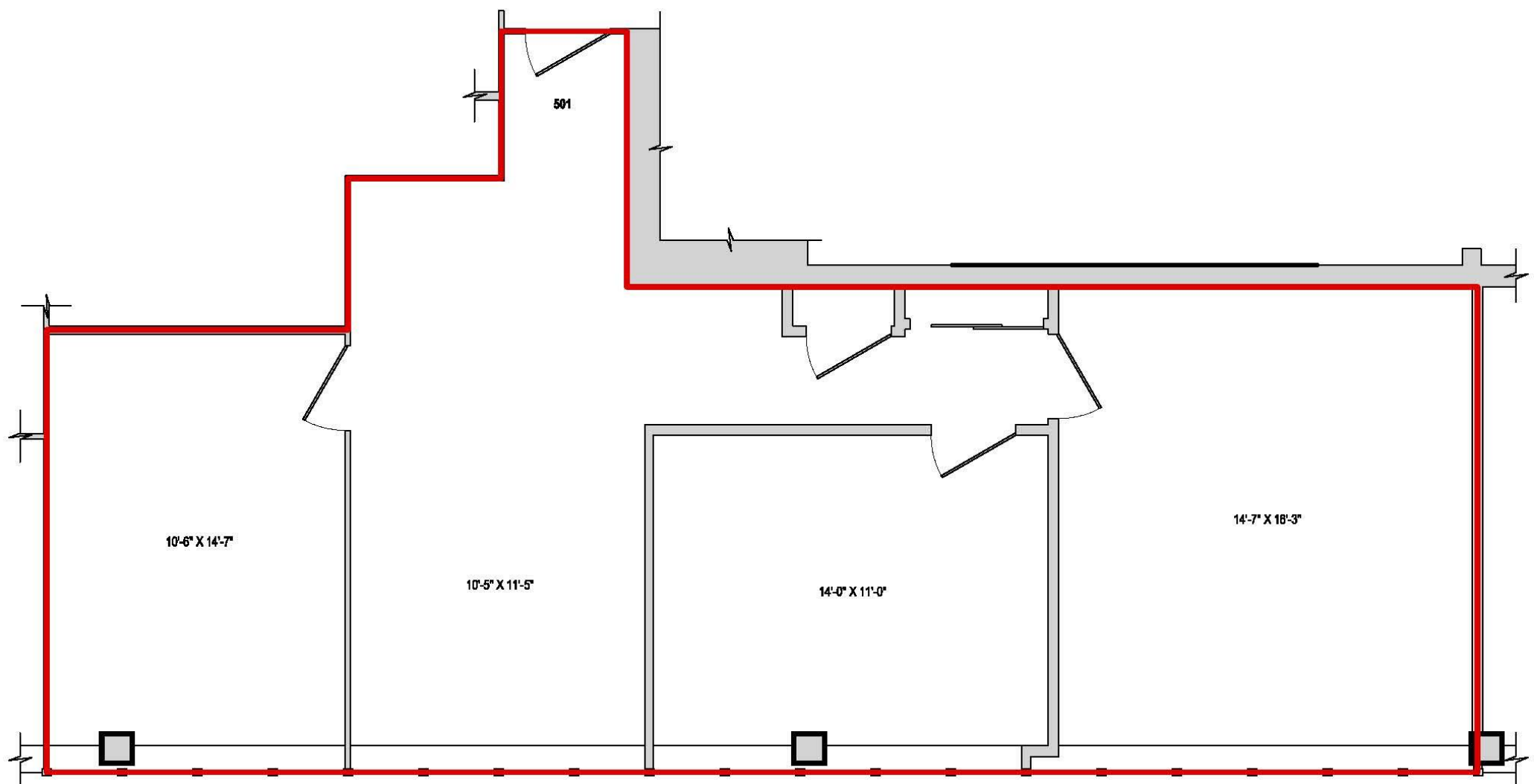

FLOOR KEY

